



ANNABEL II

Length: 30.48 metres (100')

Beam: 6.55 metres (21' 6")

Draft: 2.0 metres (6' 6")

Number of Guests: 10

Number of Crew: 5

Built: 2009

Refit: 2018

Builder: Horizon

Flag: Cook Islands

Hull Construction: Composite

Hull Configuration: Semi displacement

Air conditioning, Deck Jacuzzi, Stabilisers at anchor, WiFi connection on board

M/Y ANNABEL II was delivered in 2009 and refitted in 2018, she is a 29m Horizon design accommodating up to 10 guests, in 4 versatile cabins. Her elegant main salon is open plan with the lounge aft, formal dining forward and piano situated on the starboard side. The foyer leads to the country style galley forward, where there is further casual seating and tables. On the lower deck is a full-beam master stateroom, a full-beam VIP cabin, and 2 twin cabins, each of which can be converted into a full-width king cabin.

On deck, she features a shaded aft area with alfresco dining,

followed by a large swim platform on the transom. Moving to the foredeck, there is a comfortable seating space and raised sun pads. ANNABEL II has a generous sundeck, offering a deluxe jacuzzi, sun pads, alfresco dining, cocktail bar and partial shade.

NOTABLE FEATURES for ANNABEL II: Warm and elegant interior decor ~ Full beam master stateroom and VIP cabin ~ Convertible twin to full cabin width king beds ~ State of the art entertainment systems ~ Excellent exterior decks ideal for charter ~ Sundeck with Jacuzzi, alfresco dining and wet bar, ideal for socializing ~ Large swim platform ~ Professional and experienced crew ~ Economical fuel burn at cruising speeds ~ Stabilizers

Feedback:

~We had an amazing time, the boat is great but the crew really does the special touch, they literally look for every detail, amazing food and service. We are now looking forward to repeat again!

~Good morning! We had an amazing experience.. everything was magic and we are in love with Croatia. The crew was incredible, very kind and ready to help us in everything that we needed ♥♥♥



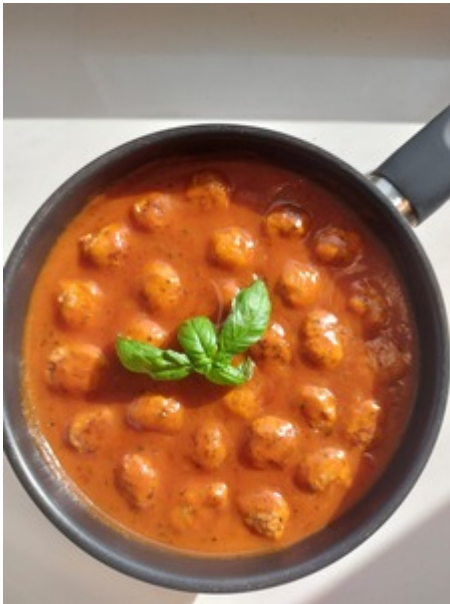







SPECIFICATIONS

ACCOMMODATION

Number of Guests: 10

Number of Cabins: 4

Cabin Configuration: 2 Double, 2 Twin

Bed Configuration: 2 Pullman, 1 King, 1 Queen

EQUIPMENT

Engines: Twin Caterpillar C-32 1550hp diesel engines,
Two Onan Generators 32kw (60hz)

Cruising Speed: 10.5 knots

Fuel Consumption: 130 Litres/Hr

WATERSPORTS

Tenders + Toys: Motor Yacht ANNABEL II has:

4.5m tender with 50hp outboard

Water skies,

Wakeboard,

One double kayak,

3 paddleboards

10 sets snorkel gear

1 x Seabiscuit

3 x sunbeds (mobile)

LAYOUT

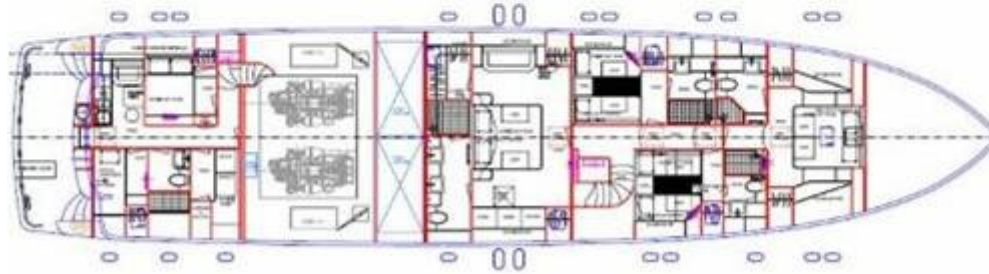
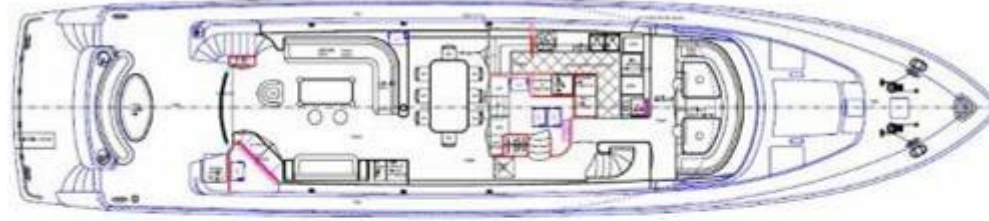
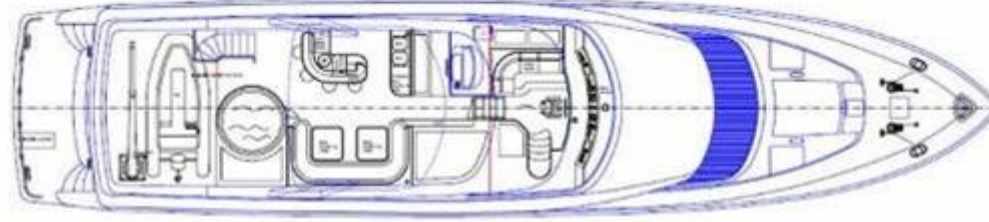

Disclaimer

This document is not contractual. All specifications are given in good faith and offered for informational purposes only. The publisher and company do not warrant or assume any legal liability or responsibility for the accuracy, completeness, or usefulness of any information and/or images displayed. Yacht inventory, specifications and charter prices are subject to change without prior notice. None of the text and/or images used in this brochure may be reproduced without written consent from the publisher.