



# AQUILA

**Length:** 37.00 metres (121' 5")

**Beam:** 7.12 metres (23' 4")

**Draft:** 2.7 metres (8' 10")

**Number of Guests:** 12

**Number of Crew:** 6

**Built:** 2006

**Refit:** 2022

**Builder:** FA CUSTOM

**Flag:** Greek

**Hull Construction:** Aluminium

**Hull Configuration:** Semi displacement

Air conditioning, WiFi connection on board



Aquila



Aquila



Aerial



Aquila



Sallon



Sallon



Sallon



Dining area



Salon and dining area



Dining area



Master Stateroom Main Deck



Master Stateroom Main Deck



Master Stateroom Main Deck



Master Stateroom Main Deck



Master Stateroom Main Deck - En suite bathroom



Master Stateroom Main Deck - En suite bathroom



Master Stateroom Main Deck - En suite bathroom



Details



Master Stateroom Main Deck - En suite bathroom / Jacuzzi



Interior details



Master Stateroom Lower Deck



Master Stateroom Lower Deck



Master Stateroom Lower Deck



VIP Stateroom





Master Stateroom Lower Deck - En suite bathroom



VIP Stateroom



Twin stateroom



Twin stateroom



External Side



Fore Deck



Fore Deck



Fore Deck



Flybridge



Flybridge



Flybridge



Flybridge



Flybridge



Water Toys

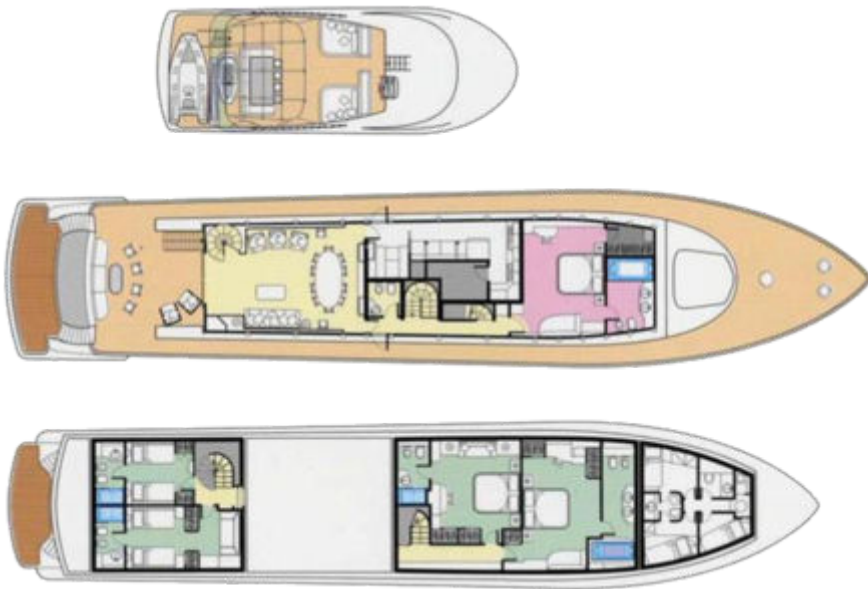

Layout



Aft Deck



Aft Deck



Aft Deck



Aft Deck



Flybridge



Swimming Platform



Aquila



Aquila - Cruising



Aquila - Cruising

# SPECIFICATIONS

## ACCOMMODATION

**Number of Guests:** 12

**Number of Cabins:** 5

**Cabin Configuration:** 3 Double, 2 Twin

**Bed Configuration:** 2 Pullman, 2 King, 1 Queen, 4 Single

## EQUIPMENT

**Engines:** Engines: 2 x 2000hp MTU

Generators: 2x 65kva

Generators Consumption: 250L per day - running  
24hours.

**Cruising Speed:** 14 knots

**Fuel Consumption:** 500 Litres/Hr

## WATERSPORTS

**Tenders + Toys:** Tender: 5.6 NOVURANIA, YAMAHA 70

hp | Length: 4.70m

- Snorkeling equipment

- Sea doo 250hp

- 2 seabob sport

- Water skis

- 2x tubes

- Kneeboard

- Flyboard

- 2x sup

- 1x wakeboard

\*More water toys upon request & extra charge

# LAYOUT

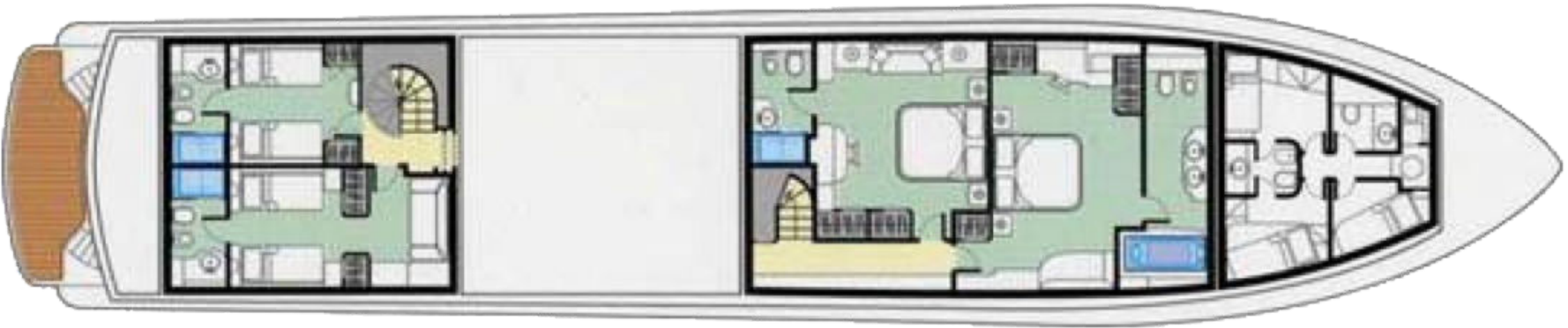
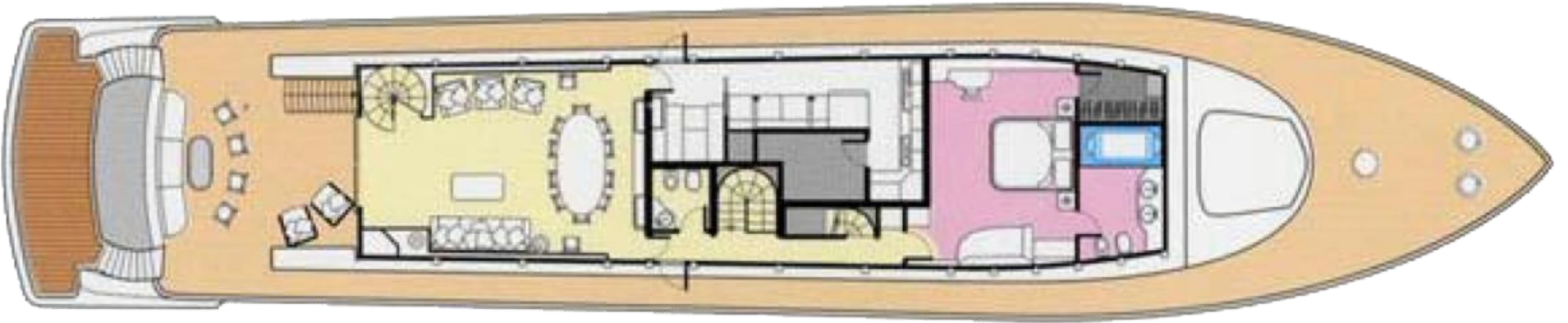
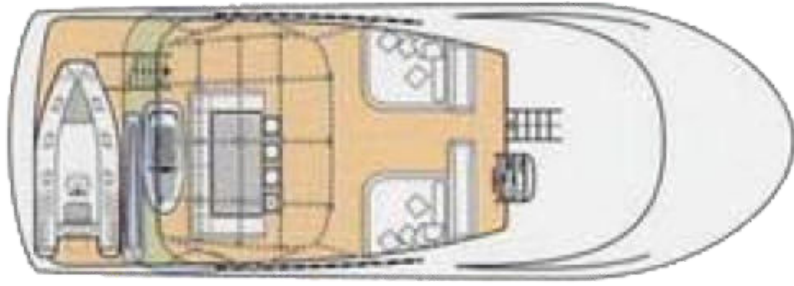



## **Disclaimer**

This document is not contractual. All specifications are given in good faith and offered for informational purposes only. The publisher and company do not warrant or assume any legal liability or responsibility for the accuracy, completeness, or usefulness of any information and/or images displayed. Yacht inventory, specifications and charter prices are subject to change without prior notice. None of the text and/or images used in this brochure may be reproduced without written consent from the publisher.