



JOY ME

Length: 49.91 metres (163' 9")

Beam: 9.12 metres (29' 11")

Draft: 2.55 metres (8' 4")

Number of Guests: 12

Number of Crew: 11

Built: 2011

Builder: Philip Zepter Yachts

Naval Architect: Philip Zepter

Flag: Croatia

Hull Construction: Steel

Hull Configuration: Displacement

Air conditioning, Deck Jacuzzi, Gym/exercise equipment, Stabilisers at anchor, Stabilisers underway, WiFi connection on board

The 50 meter trideck displacement superyacht 'joyMe built by PHILIP ZEPTEP in 2011 offers accommodation for up to 12 guests in 6 in-suite air-conditioned comfortable cabins and has crew quarters for 11 crew members. Each compartment of space within the yachts interior was treated as a separate entity with its own story and philosophy, benefiting from its own atmosphere, communicating different emotions and feelings to its guests. She has a cruising speed of 11 knots.

The interiors of 'joyMe make her a floating piece of contemporary art, and the story begins on the main deck. The

first part of saloon has being designed as the lounge area whose extension is the cockpit. Once you look deeper in the exteriors - you will be able to recognize her soul. A soul that stands out amongst even the most luxurious yachts.

The exterior areas are easily accessible and connected by large corridors. Many charming places on the open air invite you - from stern cockpit to the small sun pad in the bow tip, from the pool area to Portuguese bridge seating lounge. The joyful colors and comfortable, ergonomic seating give a hard choice on where you will want to enjoy more.

Onboard there are endless entertainment opportunities for everyone with 3.5 meter Jacuzzi and sky lounge especially attractive in the evening. The Gym, Finnish sauna & Hammam SPA with sea view and lots of water toys which provide the full charter experience.

Friends and family can fully enjoy their stay on the MY JOY ME and feel right at home with an exclusive touch.

KEY FEATURES

- 1 Accommodates up to 12 guests in 6 in-suite air-conditioned comfortable cabins
- 2 Elegant hull lines and unique styling of exterior with special colorful paint scheme of flowing lines, perforated textures and prints
- 3 3.5 meter Jacuzzi and sky lounge - The Gym, Finnish sauna & Hammam SPA with sea view
- 4 Stabilisers at anchor and underway







SPECIFICATIONS

ACCOMMODATION

Number of Guests: 12

Number of Cabins: 6

Cabin Configuration: 3 Double, 3 Twin

Bed Configuration: 2 Twin with Pullman, 2 King + 1 Queen

EQUIPMENT

Engines: MAIN ENGINES 2 X Cummins KTA-38-M1, 12 cylinder

MAIN GENERATORS 3 x Cummins 6CTA8.3-D(M)

Cruising Speed: 11 knots

Fuel Consumption: 250 Litres/Hr

WATERSPORTS

Tenders + Toys: 6m Zodiac tender with Volvo 150HP jet drive, Sea-doo Wake Pro 230 (3-seater, also designed for wakeboarding and waterskiing), Yamaha 3-person waverunner, Waterskis (including for children), Wakeboard, Inflatable towable toys (banana, donuts, seat), 2 x GoCycle electric bikes, 2 x standup paddleboards, Snorkelling equipment, 2 seabobs

LAYOUT

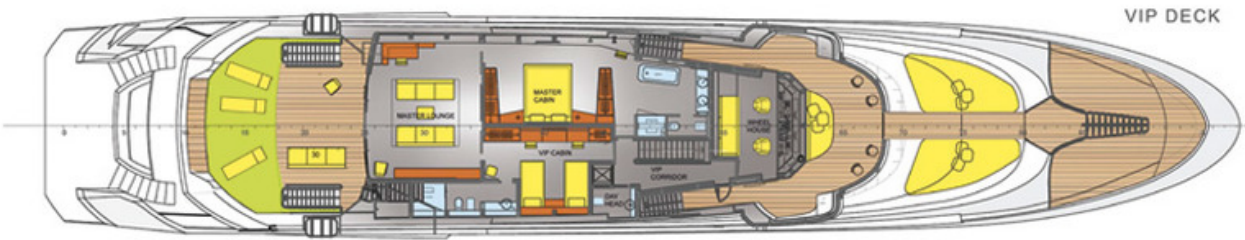

VIP DECK

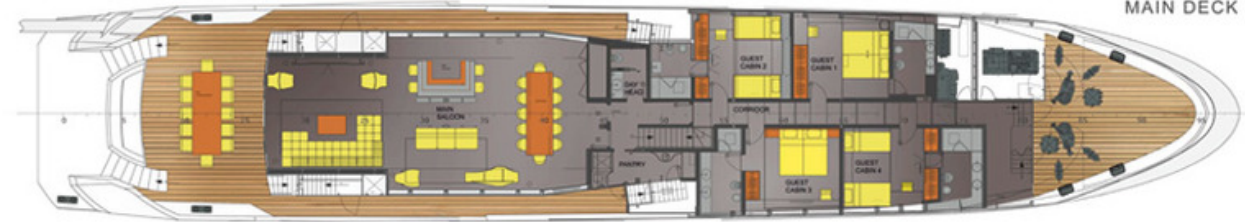

MAIN DECK

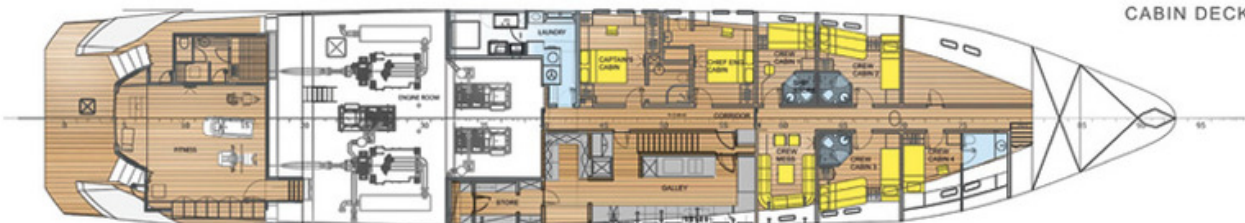

CABIN DECK

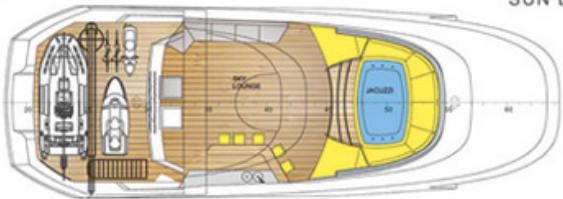

SUN DECK

Disclaimer

This document is not contractual. All specifications are given in good faith and offered for informational purposes only. The publisher and company do not warrant or assume any legal liability or responsibility for the accuracy, completeness, or usefulness of any information and/or images displayed. Yacht inventory, specifications and charter prices are subject to change without prior notice. None of the text and/or images used in this brochure may be reproduced without written consent from the publisher.