



NAFISA

Length: 33.00 metres (108' 3")

Beam: 8.00 metres (26' 3")

Draft: 2.1 metres (6' 11")

Number of Guests: 10

Number of Crew: 6

Built: 1975

Refit: 2020

Builder: Admiral

Naval Architect: Cantieri Lavagna

Flag: Italian

Hull Construction: Wood

Hull Configuration: Planing hull

Air conditioning, Deck Jacuzzi, Gym/exercise equipment, WiFi connection on board

A splendid example of Italian shipbuilding, Nafisa is a classic "Gentlemen's yacht" with its expansive deck spaces that make her ideal to those who really wish to experience life on the sea. Rebuilt in 1995, Nafisa is in excellent conditions also thanks to several refits and upgrades, the 2019-2020 refit that included, among others, the creation of a new ensuite bathroom for the main deck cabin, a coffee room next to the galley and the building of a beautiful sundeck over the current shaded alfresco dining area, to offer extra space to sunbathe and enjoy the surrounding panoramas.

She offers comfortable accommodation for 10 guests in a magnificent full beam Owner's stateroom, a VIP suite, 2 spacious twin cabins and 1 additional double cabin. Nafisa boasts very ample open spaces, offering a variety of different seating and lounging areas: on the fly bridge, two huge sofas, an al fresco dining area and a fantastic 4 seats Jacuzzi to relax while admiring the breathtaking views of the Mediterranean landscapes. On the main deck Nafisa hosts a huge salon, a beautiful relax area at stern with a coffee table and sofas and a beautiful solarium on the foredeck. She also boasts a full gym equipment with stationary bike, stepper, yoga mat, weights, kettlebell, elastics, resistance band. Nafisa's cruising speed is 13 kn but she can cruise at a lower speed of 11 kn with a reduced fuel consumption of 220 Litres/Hr .

Stable, comfortable and stylish, Nafisa is the perfect choice for unforgettable cruising holidays.

For further information please visit NAFISA BF website <http://motor-yacht-nafisa.weebly.com/>

KEY FEATURES

- 1** Incredible seaworthiness
- 2** Constantly maintained and upgraded
- 3** Comfortable accommodation for up to 10 guests
- 4** Long experienced Captain and Crew
- 5** Wide array of Tender&Toys
- 6** Wonderful Jacuzzi and Brand New Water Slide
- 7** Extensive open deck spaces



Aerial View



Foredeck Solarium



Jacuzzi



Aft deck al fresco breakfast table



Flybridge Sofa



New Sundeck area



Cyclette



Main Salon



Salon with tv detail and sofas



Sundeck al fresco dining area



Galley



Coffee Room



Master Cabin



Master Cabin Vanity Table



Double Suite



Master Cabin Bathroom



Twin Cabin



Double Cabin



Twin Cabins' bed



Twin Cabin's bed



Twin Cabin Bathroom



Fish first course



Fish fry



Floreal Table Setting



At sunset



Master Cabin Shower



Double Suite Bathroom



Jacuzzi and Water Toys



Brand New Water Slide



Double Cabin's tv detail



Twin Cabin 2



Sailing



Foredeck Solarium with view



Layout



Nafisa's Crew



SPECIFICATIONS

ACCOMMODATION

Number of Guests: 10

Number of Cabins: 5

Cabin Configuration: 3 Double, 2 Twin

Bed Configuration: 1 King, 2 Double, 4 Single

EQUIPMENT

Engines: 2x 1700 hp MTU . 3 x generators . 1 x 53KW, 1 x 36 KW, 1 x 16 KW.

Fuel consumption at reduced cruising speed 11 knots: 220 lt/h.

Cruising Speed: 13 knots

Fuel Consumption: 350 Litres/Hr

WATERSPORTS

Tenders + Toys: Tender Lomac 6 mt. 100 hp Yamaha, Tender Stilmar 7 mt. 200 hp Honda four-stroke, Donuts, Snorkelling equipment, waterski, inflatable toys, 1 New waverunner (3 seats), 2 kayaks, 4 new inflatable and rigid SUPs (Stand Up paddleboard), 2 New Canoes, 1 new Windsurf, 1 Wakeboard, 1 Brand New Water Slide

LAYOUT

Main Deck

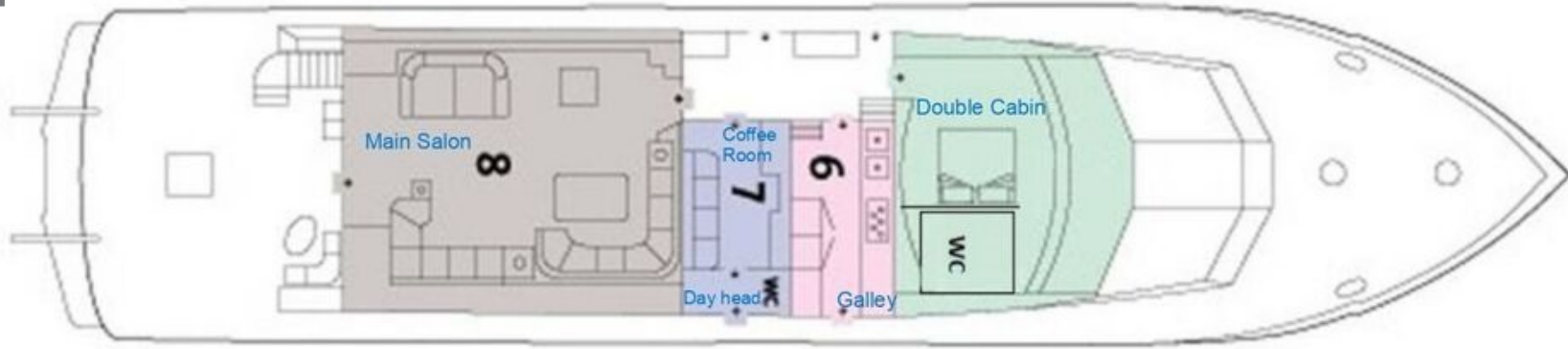

Lower Deck

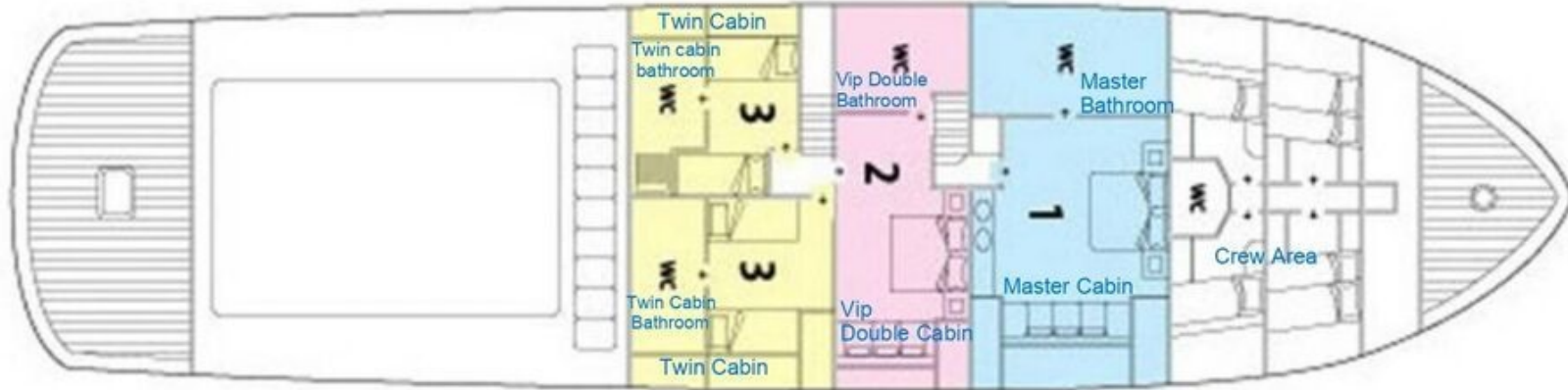

Disclaimer

This document is not contractual. All specifications are given in good faith and offered for informational purposes only. The publisher and company do not warrant or assume any legal liability or responsibility for the accuracy, completeness, or usefulness of any information and/or images displayed. Yacht inventory, specifications and charter prices are subject to change without prior notice. None of the text and/or images used in this brochure may be reproduced without written consent from the publisher.