



SERENISSIMA

Length: 20.42 metres (67')

Beam: 10.46 metres (34' 4")

Draft: 3.00 metres (9' 10")

Number of Guests: 10

Number of Crew: 3

Built: 2019

Builder: Fountaine Pajot

Naval Architect: Berret-Racoupeau Yacht Design

Flag: Maltese

Hull Construction: GRP

Hull Configuration: Multi hull

Air conditioning,

WiFi connection on board,

Laptop & printer,

BBQ

TV in the saloon

Shower gel, shampoo, conditioner, body milk, sewing kit

Hairdryers (5)

Iron (1)

Washing machine/ dryer (light laundry)

Bathrobes for each guest

Pillows on each bed (4)

hallmark features. Experience the exhilaration of sailing or simply relaxing on the decadent lounges or sunbathing beds. Her stunning interior is boldly modern and incredibly spacious to deliver the ultimate in comfort and luxury. She accommodate 10 guests in five cabins - one owner's suite and 4 queen bed cabins all with private bathrooms. The flybridge together with the forward deck offers plenty of space for sunbathing and relaxing and the aft cockpit a great area for socialising and alfresco dining. Our crew consisting of a captain, hostess and chef will look forward to pampering guests on board without leaving any wish unfulfilled. Serenissima is committed to offer all our distinguished guests a calm and luxurious environment.

S/Y Serenissima is pure luxury in a catamaran her expansive flybridge with an authentic ocean terrace and a forward cockpit with extensive seating area... are just some of her

KEY FEATURES

- 1** Extensive outdoor areas
- 2** Superior Fly Bridge
- 3** Modern Design
- 4** Decadent Lounges
- 5** Number of Water Toys



Sistership - Flybride



Sistership



Sistership - Master cabin



Sistership - Master cabin



Sistership - Master bathroom



Sistership - Hydraulic Bathing platform





Sistership - Fly Bridge



Sistership - Fly bridge





Sistership - Double cabins



Sistership





Sistership

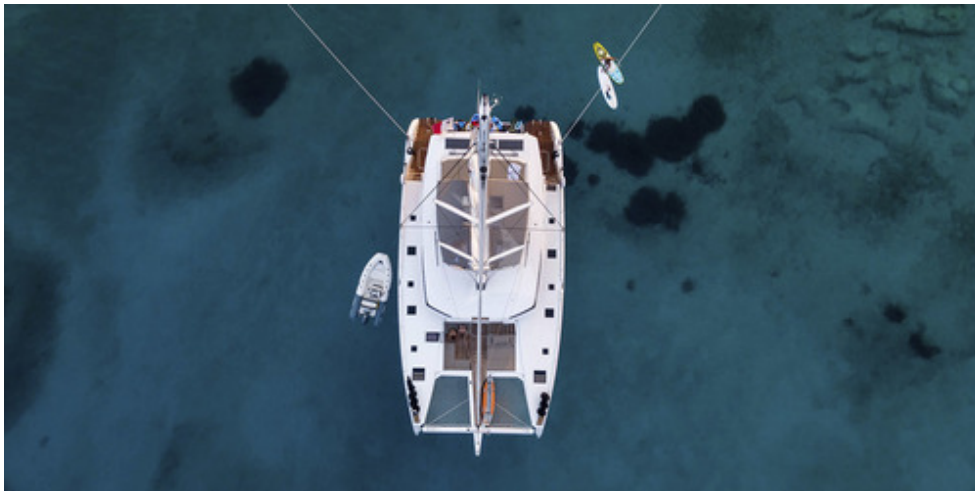



Sistership



Sistership - Aft dining area



Sistership - Wet bar/Barbeque

SPECIFICATIONS

ACCOMMODATION

Number of Guests: 10

Number of Cabins: 5

Cabin Configuration: One master cabin with queen size bed, 4 double cabins with queen size bed all with private facilities

Bed Configuration: 5 Queen

EQUIPMENT

Engines: 2 x 300 HP

Fischer Panda 6 KVA Onan 17 KVA

Cruising Speed: 10 knots

Fuel Consumption: 30 Litres/Hr

WATERSPORTS

Tenders + Toys: T/T - Lomac 460 with 60 hp Yamaha engine

Water skis adults (2)

Water skis kids (1)

Wakeboard (1)

Monoski (2)

Monoski kids (1)

Inflatable tubes (1)

Inflatable donut (1)

Fishing gear (2)

Snorkeling gear (10)

Kayak 2 pax (1)

SUP (2)

Sea Wings (4)

LAYOUT

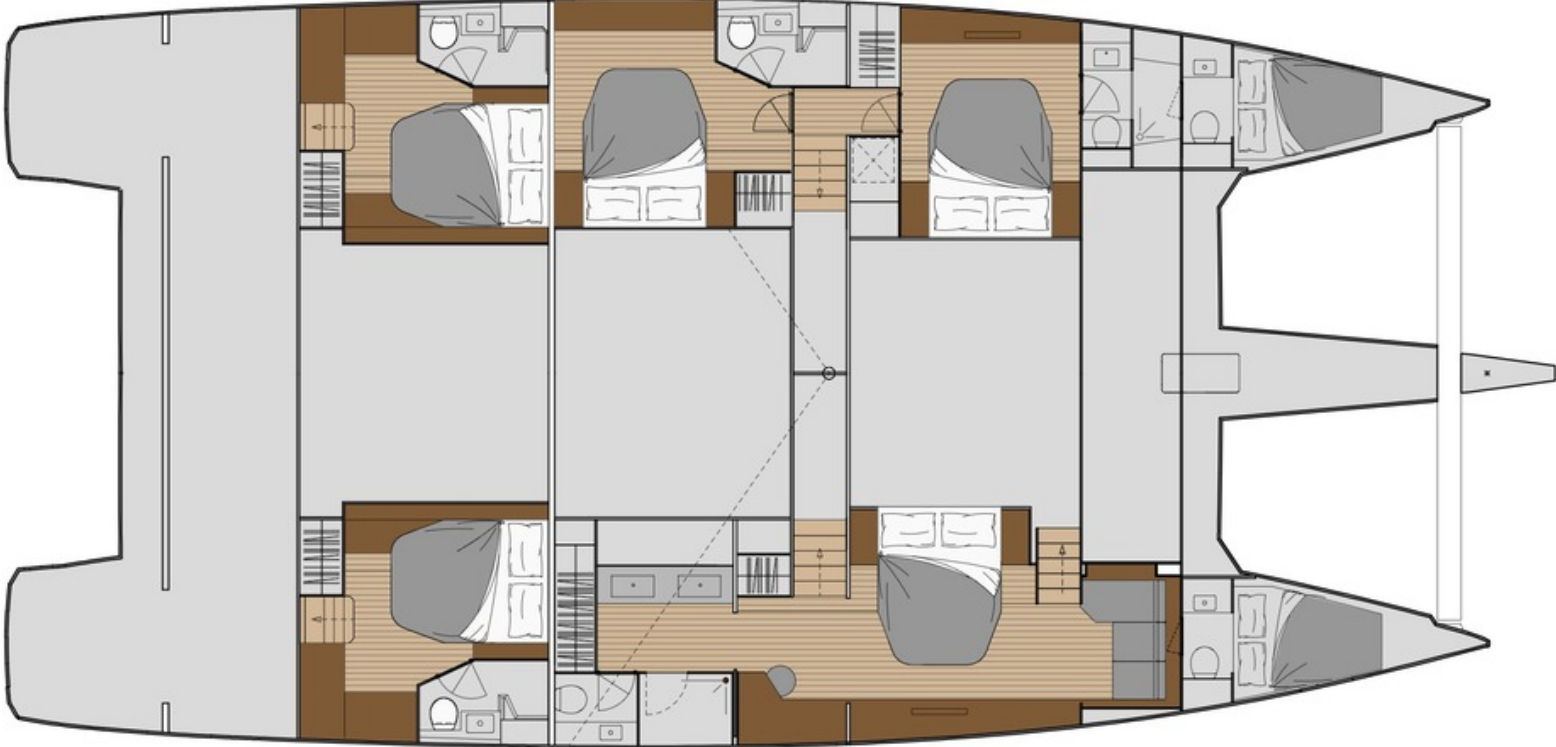

Disclaimer

This document is not contractual. All specifications are given in good faith and offered for informational purposes only. The publisher and company do not warrant or assume any legal liability or responsibility for the accuracy, completeness, or usefulness of any information and/or images displayed. Yacht inventory, specifications and charter prices are subject to change without prior notice. None of the text and/or images used in this brochure may be reproduced without written consent from the publisher.