



SKYLARK

Length: 21.34 metres (70')

Beam: 9.27 metres (30' 5")

Draft: 1.52 metres (5')

Number of Guests: 8

Number of Crew: 3

Built: 2012

Builder: Sunreef Yachts

Naval Architect: Sunreef Yachts

Flag: Maltese

Hull Construction: GRP

Hull Configuration: Multi hull

Air conditioning, WiFi connection on board

stability both at anchor and underway. SKYLARK is as powerful as she is efficient. Low fuel consumption is just one of the many attributes that make SKYLARK the perfect yacht for your next vacation. Boasting an exterior that's just as impressive, SKYLARK features a spacious sunbed on the fly for you and your guests to enjoy. The perfect spot for those cool nights on the water, the sun deck offers ample seating areas for sunbathing, lounging, or dining al fresco! SKYLARK also features a generous swim platform, perfect for a quick dip or a day on the water. However you choose to spend your next Mediterranean yacht vacation, let SKYLARK take you there.

Who's ready for the trip of a lifetime aboard a luxury catamaran? Introducing SKYLARK, an 70' (21.34m) Catamaran built by the renowned Sunreef Yachts. Ideal for cruising the stunning Mediterranean waters, SKYLARK offers world-class service with unparalleled 360° ocean views. Four well-appointed staterooms will greet you with plush comfort upon arrival. The generous full-beam master stateroom is outfitted in contemporary wood finishings and a panoramic ocean view from the moment you wake up. Her modern yet organic atmosphere offers unique wood finishings, allowing for the ideal oasis.

Boasting a multi-hull design, SKYLARK provides maximum

KEY FEATURES

- 1** Low Fuel Consumption
- 2** Friendly Crew
- 3** Spacious and Stable
- 4** Addition of a large sunbed on the fly last winter
- 5** Open plain main deck for a family spirit onboard



Owner's Stateroom



Owner's Stateroom



Owner's En Suite



Guest Stateroom



Guest Stateroom



Guest Stateroom



Galley



Bridge



Main Deck





Beach Club





SPECIFICATIONS

ACCOMMODATION

Number of Guests: 8

Number of Cabins: 4

Cabin Configuration: not specified

Bed Configuration: 1 Pullman, 3 Queen, 1 Double

EQUIPMENT

Engines: Engines: 2 x MAN R6-800 - Generator: 2 x Cummins 19 k

Cruising Speed: 12 knots

Fuel Consumption: 50 Litres/Hr

WATERSPORTS

Tenders + Toys: • Adult water skis

- Windsurfer
- Wakeboard
- Snorkel gear
- 1 Inflatable kayak
- 2 x Paddleboards
- Sea-Doo Aqua Lounge 6 Inflatable Island
- Round donut for towing
- Fishing equipment

LAYOUT

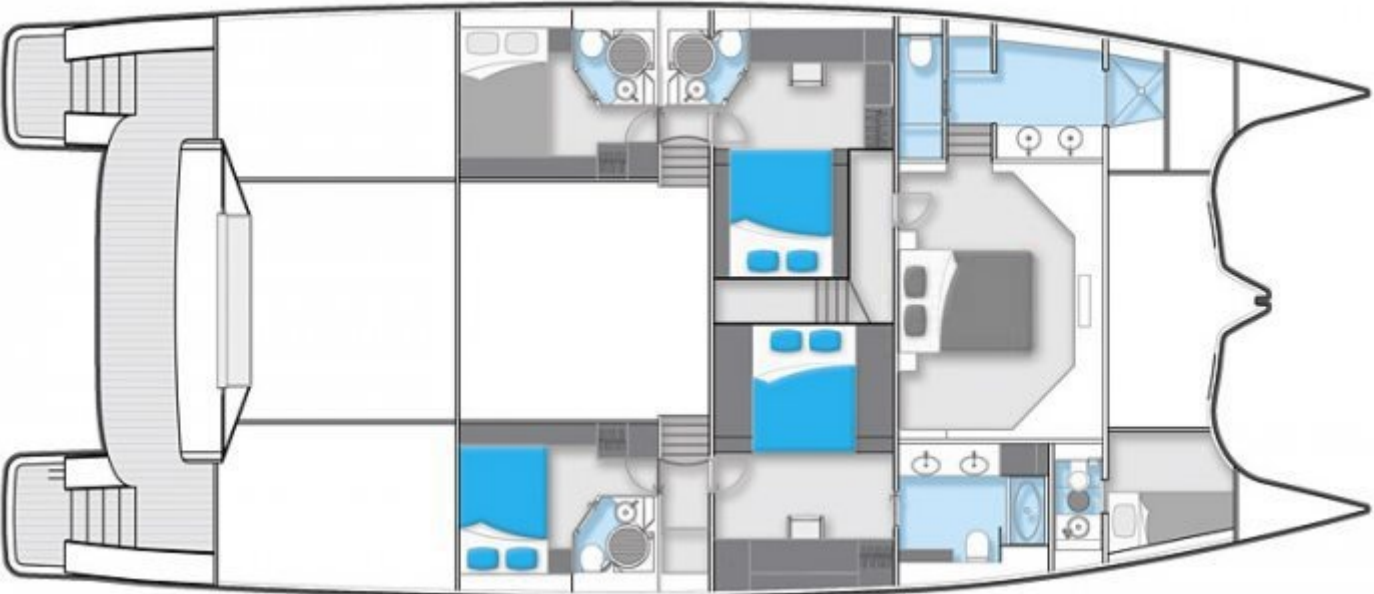

Disclaimer

This document is not contractual. All specifications are given in good faith and offered for informational purposes only. The publisher and company do not warrant or assume any legal liability or responsibility for the accuracy, completeness, or usefulness of any information and/or images displayed. Yacht inventory, specifications and charter prices are subject to change without prior notice. None of the text and/or images used in this brochure may be reproduced without written consent from the publisher.